

# DocuPrint CP475 AP

Smart gateway to the new workstyle.



# Intelligent and compact A4 colour printer supporting your smart workstyle.

DocuPrint CP475 AP delivers superb printing image quality, high connectivity and productivity, and intuitive user experience with colour touch panel. Caters to a variety of requirements from workgroup to enterprise customers.



## DocuPrint CP475 AP



- Intelligent colour printer
- Print up to 40 ppm
- 5-inch colour touch panel
- Print resolution up to 1200 x 2400 dpi
- USB, Ethernet, Wi-Fi\*<sup>2</sup> connectivity

\*1: Pages per minute.

\*2: Optional.



### Intelligence

- Advanced operability with 5-inch colour touch panel. You can personalize the icons on the screen to make your regular workflow easier and faster.
- Whether as a desktop or a console device, the adjustable touch panel lets you easily operate the device. Comfortable sound and light navigate you to the intuitive user experience.
- You can refer to FAQ and user instructions on **Help screen** when you have questions on how to use. Colour animation on the touch panel assists you to solve the operation troubles easily.

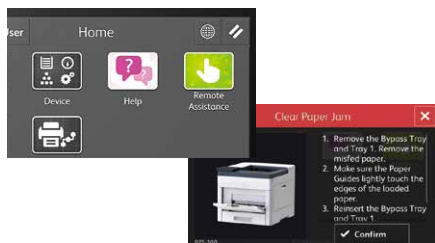

Even if you cannot solve the trouble by yourself, **Remote Assistance** helps you. The call center staff remotely operates your touch panel for trouble shooting.

- Device management and cost control is easy with ApeosWare Management Suite 2\*, which can manage devices and their usages, and provides integrated authentication, print output, and log accounting.

\* Software sold separately. Planned to be supported.



### Connectivity & security

- Perfect for fast-moving mobile workers who need to print out something while on the move. You can easily print from mobile devices using **Print Utility**\*<sup>1</sup>, **AirPrint**, and **Mopria Print Service**. When using Print Utility, the printing device is identified just by holding your mobile device\*<sup>2</sup> over the NFC area on the panel. Easy and simple operation helps busy workers.



\*1: Print Utility is free application provided by Fuji Xerox.

\*2: NFC-enabled device is required.

- Prevents paper information leakage with **Secure Print** and **Private Charge Print** with IC card authentication\*. With Image Log\*, job logs and the image itself can be stored and managed, enabling prompt investigation upon information leakage.

\* Optional.

- 360° security realized with various measures such as communication route encryption, data encryption, access log, and usage restrictions. Reliable partner for your business continuity.



### Productivity

- Attention-grabbing print quality with Super EA-Eco toner and LED Printhead, while offering fast printing of 40 ppm at the same time.

- Flexibly caters to your business needs with optional 550-Sheet Feeder and Cabinet. You can expand the paper feeding capability up to 2350\* sheets at maximum.

\* When three 550-Sheet Feeders are installed at maximum. Based on 80 gsm paper.

- High reliability with robust design for 300000-page machine life. Tough partner for high-volume printing environment.

- Energy saving with Super EA-Eco toner with low fusing temperature.

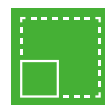

### Compact

- With compact design, DocuPrint CP475 AP can be installed just the way you like. As a desktop device, under a counter, or a console central printer.



## User-friendly colour touch panel

When using Private Charge Print, you can easily select and delete the documents viewing the thumbnails shown on the panel. Convenient for saving time and waste.

You can also select your favorite photos from the panel when printing the photo data from your USB memory\*.

\* Optional.



5-inch colour touch panel



USB port



## Smart & scalable

### 1 5-inch colour touch panel:

Intuitive colour touch panel lets you find just what you want at a glance.

### 2 USB port\*:

Use your own USB memory to print directly from the USB.

\* Optional.

### 3 IC card reader\*:

You can use Private Charge Print with your IC card.

\* Optional.

### 4 Bypass Tray:

Can print on various paper types such as envelopes and postcards.

### 5 Standard Tray (550 sheets):

For standard users. Supports various types & sizes of paper.

### 6 550-Sheet Feeder\*1 (550 sheets):

Paper feeding capacity is 2350\*2 sheets at maximum. High scalability for high-volume printing needs.

\*1: Optional.

\*2: When three 550-Sheet Feeders are installed.

### 7 Caster\*:

For easy installation and moving on the floor.

\* Optional.

### 8 Cabinet\*:

Convenient for storing paper and consumables.

\* Optional.



# DocuPrint CP475 AP Functions & Specifications

## Functions & Specifications

| Item                                     | Description   |
|--|---|
| Printing Method                          | LED Xerography <sup>*1</sup>  |
| Warm-up Time                             | 38 seconds or less (23 degrees Celsius room temperature). 20 seconds or less from Sleep Mode.   |
| Continuous Print Speed <sup>*2</sup>     | Simplex Colour: 40 ppm, B/W: 40 ppm   |
|  | Duplex Colour: 26.9 ppm, B/W: 26.9 ppm  |
| First Print Output Time <sup>*3</sup>    | Colour: 8.0 sec. (A4), B/W: 8.0 sec. (A4)   |
| Printing Resolution                      | Standard [PCL Driver]<br>Standard: 1200 x 2400 dpi, High Quality: 1200 x 2400 dpi, High Resolution: 1200 x 1200 dpi   |
|  | Optional [Adobe® PostScript® 3™ Driver]<br>High Speed (Standard): 600 x 600 dpi, High Quality: 1200 x 2400 dpi, High Resolution: 1200 x 1200 dpi  |
| Paper Size                               | Standard Tray A5, JIS B5, ISO B5, A4, Statement (139.7 x 215.9 mm), Executive (184 x 267 mm), Letter, 8.5 x 13" (215.9 x 330.2 mm), Legal, Custom Size (Width: 76.2 to 215.9 mm, Length: 190 to 355.6 mm)   |
|  | Bypass Tray A6, JIS B6, A5, A5 LEF, JIS B5, ISO B5, A4, Statement (139.7 x 215.9 mm), Executive (184 x 267 mm), Letter, 8.5 x 13" (215.9 x 330.2 mm), Legal, COM-10, Monarch, DL, CS, Custom Size (Width: 76.2 to 215.9 mm, Length: 127 to 355.6 mm)                                    |
|  | Optional Tray 550-Sheet Feeder: A5, JIS B5, ISO B5, A4, Statement (139.7 x 215.9 mm), Executive (184 x 267 mm), Letter, 8.5 x 13" (215.9 x 330.2 mm), Legal, Custom Size (Width: 76.2 to 215.9 mm, Length: 190 to 355.6 mm)   |
|  | 2 Sided Printing A4, JIS B5, A5, Letter, 8.5 x 13" (215.9 x 330.2 mm), Legal, Executive (184 x 267 mm), Custom Size (Width: 139.7 to 215.9 mm, Length: 203.2 to 355.6 mm)   |
| Paper Weight <sup>*4</sup>               | Standard Tray 60 to 220 gsm   |
|  | Bypass Tray 60 to 220 gsm   |
|  | Optional Tray 550-Sheet Feeder: 60 to 220 gsm   |
|  | 2 Sided Printing 60 to 176 gsm  |
| Paper Tray Capacity <sup>*5</sup>        | Standard Standard Tray: 550 sheets<br>Bypass Tray: 150 sheets   |
|  | Optional 550-Sheet Feeder: 550 sheets   |
|  | Max 2350 sheets [Standard + 550-Sheet Feeder x 3]   |
| Output Tray Capacity <sup>*5</sup>       | 250 sheets  |
| CPU                                      | ARM Dual Core 1.3 GHz   |
| Memory Capacity                          | 4 GB (Max: 4 GB)  |
| Storage Device Capacity <sup>*6</sup>    | 3.6 GB, Optional: 128 GB <sup>*7</sup>  |
| Page Description Language                | Standard PCL5 / PCL6  |
|  | Optional Adobe® PostScript® 3™  |
| Supported Operating System <sup>*8</sup> | Standard [PCL Driver]<br>Windows 10 (32 bit / 64 bit), Windows 8.1 (32 bit / 64 bit), Windows Server 2019 (64 bit), Windows Server 2016 (64 bit), Windows Server 2012 R2 (64 bit), Windows Server 2012 (64 bit)<br>[Mac OS X Driver]<br>macOS 10.15 / 10.14 / 10.13 / 10.12, OS X 10.11 |
|  | Optional [Adobe® PostScript® 3™ Driver]<br>Windows 10 (32 bit / 64 bit), Windows 8.1 (32 bit / 64 bit), Windows Server 2019 (64 bit), Windows Server 2016 (64 bit), Windows Server 2012 R2 (64 bit), Windows Server 2012 (64 bit)<br>macOS 10.15 / 10.14 / 10.13 / 10.12, OS X 10.11    |
| Interface                                | Standard Ethernet 1000BASE-T / 100BASE-TX / 10BASE-T, USB3.0, USB2.0  |
|  | Optional Wireless LAN (IEEE 802.11 a / b / g / n / ac)  |
| Network Protocol                         | TCP/IP (Ipd, IPP, Port9100)   |
| Power Supply <sup>*9</sup>               | AC220-240 V +/- 10 %, 8 A, 50/60 Hz common  |
| Operating Noise <sup>*10,11</sup>        | In Operation: 6.9 B, 53.5 dB (A)<br>Ready Mode: 4.9 B, 33.2 dB (A)  |
|  | 1410 W  |
| Maximum Power Consumption                | Max 0.5 W   |
|  | Sleep Mode 0.5 W  |
| Average                                  | Ready Mode: 70 W, In Operation: 715 W   |
|  | 1410 W  |
| Dimensions                               | W 427.4 x D 465.7 <sup>*12</sup> x H 407.4 <sup>*13</sup> mm  |
| Weight <sup>*14</sup>                    | 28.0 kg (Including consumables and drum)  |
|  | 24.0 kg (Excluding consumables and drum)  |

\*1: LED + Xerographic.

\*2: When Continuously Printing Original in A4 (Plain). The performance may be reduced depending on the paper type and the paper size. The speed may be reduced due to the image quality adjustment.

### Notes

- To comply with paper weight specifications, it is recommended to use Fuji Xerox recommended paper. Document may not be printed correctly depending on usage conditions.
- Functional spare parts will be available for at least 7 years after the product is no longer manufactured.

Apple, iPhone, AirPrint, iPad, iPad Air, iPad Pro, iPod touch, and Mac are trademarks of Apple Inc., registered in the U.S. and other countries.

All product names and company names mentioned in this brochure are trademarks or registered trademarks of their respective companies.

The product specifications, appearance and other details in this brochure are subject to change without notice for improvements.

The available model varies depending on the country/region. Please ask the sales representatives for details.

**Reproduction Prohibitions** Please note that reproduction of the following is prohibited by law : Domestic and foreign currencies, government-issued securities, and national bonds and local bond certificates, Unused postage stamps, post cards, etc. Certificate stamps stipulated by law. Reproducing works forming the subject matter of copyright (literary works, musical works, paintings, engravings, maps, cinematographic works, drawings, photographic works, etc.) is not permitted unless the reproduction is for the purpose of personal use, family use or other similar uses within a limited circle.

**For Your Safety**  
Before using the product, read the Instruction Manual carefully for proper use. Use the product with the power source and voltage specified. Be sure to establish ground connection. Otherwise, electronic shock may result in the case of a failure or short circuit.

For more information or detailed product specification, please call or visit us at

**Fuji Xerox Singapore Pte Ltd**

80 Anson Road, #01-01 Fuji Xerox Towers Singapore 079907

Tel.65-6766-8888

<https://www.fujixerox.com.sg/>



\*3: When feeding from feeder tray of machine. Numeric value varies depending on output environment.

\*4: It is recommended to use Fuji Xerox recommended paper. Correct print output may not be possible depending on the requirement.

\*5: 80 gsm paper.

\*6: The Storage Device Capacity is not totally available for customers.

\*7: When the optional Storage (SSD) is installed.

\*8: Please refer to our official website for the latest supported OS.

\*9: Power outlets that provide the above power level is recommended. Maximum machine measured current 8 A.

\*10: Measured in accordance to ISO7779. Unit B: Sound Power Level LWAd, Unit dB: Radiated Sound Pressure Level LpAm (bystander position), as reference value.

\*11: Main unit only.

\*12: CI Badge is excluded. When CI Badge is included, 2.7 mm is added.

\*13: 550-Sheet Feeder (height): 123 mm (The height increment when the option is installed).

\*14: Including Toner Cartridge, 550-Sheet Feeder: 6.6 kg.

## Options

| Product Name                    | Product Code |
|---------------------------------|--------------|
| 550-Sheet Feeder                | EC103493     |
| Caster                          | EC103495     |
| Cabinet                         | EL500294     |
| Wireless LAN Kit                | EC103915     |
| Storage (SSD)                   | EC103918     |
| Foreign Device Interface-A-14   | E9100157     |
| Adobe® PostScript® 3™ Kit       | EC103933     |
| Adobe® PostScript® 3™ Kit label | ED201136     |
| Multi-Language Font Kit         | EC101145     |
| USB Memory Kit                  | EC103976     |
| Security Expansion Kit          | EC103941     |
| Network Accounting Kit          | EC103978     |
| TC/SC Additional Font ROM Kit   | EC103980     |
| External IC Card Reader B       | EC103320     |

## Consumables

| Product Name                          | Product Code | Product Life                     |
|---------------------------------------|--------------|----------------------------------|
| Drum Cartridge Black (Starter)        | —            | Up to 60,000 pages <sup>*1</sup> |
| Drum Cartridge Yellow (Starter)       | —            | Up to 60,000 pages <sup>*1</sup> |
| Drum Cartridge Magenta (Starter)      | —            | Up to 60,000 pages <sup>*1</sup> |
| Drum Cartridge Cyan (Starter)         | —            | Up to 60,000 pages <sup>*1</sup> |
| Drum Cartridge Black                  | CT351220     | Up to 60,000 pages <sup>*1</sup> |
| Drum Cartridge Yellow                 | CT351223     | Up to 60,000 pages <sup>*1</sup> |
| Drum Cartridge Magenta                | CT351222     | Up to 60,000 pages <sup>*1</sup> |
| Drum Cartridge Cyan                   | CT351221     | Up to 60,000 pages <sup>*1</sup> |
| Toner Cartridge Black (Starter)       | —            | Up to 7,000 pages <sup>*2</sup>  |
| Toner Cartridge Yellow (Starter)      | —            | Up to 5,000 pages <sup>*2</sup>  |
| Toner Cartridge Magenta (Starter)     | —            | Up to 5,000 pages <sup>*2</sup>  |
| Toner Cartridge Cyan (Starter)        | —            | Up to 5,000 pages <sup>*2</sup>  |
| Toner Cartridge Standard Black        | CT203342     | Up to 7,000 pages <sup>*2</sup>  |
| Toner Cartridge Standard Yellow       | CT203345     | Up to 5,000 pages <sup>*2</sup>  |
| Toner Cartridge Standard Magenta      | CT203344     | Up to 5,000 pages <sup>*2</sup>  |
| Toner Cartridge Standard Cyan         | CT203343     | Up to 5,000 pages <sup>*2</sup>  |
| Toner Cartridge High-capacity Black   | CT203346     | Up to 15,000 pages <sup>*2</sup> |
| Toner Cartridge High-capacity Yellow  | CT203349     | Up to 11,000 pages <sup>*2</sup> |
| Toner Cartridge High-capacity Magenta | CT203348     | Up to 11,000 pages <sup>*2</sup> |
| Toner Cartridge High-capacity Cyan    | CT203347     | Up to 11,000 pages <sup>*2</sup> |
| Fusing unit 220v                      | CWAA0959     | Up to 100,000 pages              |
| Transfer Module                       | CWAA0960     | Up to 100,000 pages              |
| Waste Toner Cartridge                 | EL500293     | Up to 30,000 pages <sup>*3</sup> |
| Paper Roller Kit                      | EC103505     | Up to 100,000 pages              |

\*1: The number of printable pages is a reference value derived from the average of 3 sheets printed in A4, 1 sided, image coverage per colour 5 %. Colour/Monochrome rate 50 : 50 in one setting, under continuous printing usage conditions. The actual number of printable pages may vary to below half the reference value, depending on paper type, paper direction, input/output tray settings, initialization operations upon powering ON/OFF the device, tuning operations to maintain print quality, and other such usage environment conditions.

\*2: Published value based on ISO/IEC 19798 standards. The actual number of printable pages may vary significantly from the published value, depending on printing content, paper size, paper type, usage conditions, initialization operations upon powering ON/OFF the device, tuning operations to maintain print quality, and other such usage environment conditions.

\*3: The number of printable pages is a reference value when printing in A4, 1 sided, image coverage per colour 5 %. Colour/Monochrome rate 50 : 50. The actual number of printable pages may vary significantly from the reference value, depending on printing content, paper size, paper type, usage conditions, initialization operations upon powering ON/OFF the device, tuning operations to maintain print quality, and other such usage environment conditions.